



# Neighbourhood Committee meeting – Édouard- Montpetit sector

2019-06-12

Réseau  
express  
métropolitain



 NouvLR

# Agenda

- Welcome and presentation of the agenda
- Follow-ups from the last neighbourhood committee meeting
- Community relations
- Status of ongoing and upcoming work
- **Question & answer period**



# Follow-ups from the last neighbourhood committee meeting



# Follow-ups

## **Forwarding of the Environmental and Social Management Plan for the Édouard-Montpetit construction site**

- Excerpts relevant to the construction site were forwarded to committee members on April 5

## **Assessment of the possibility of blasting on weekends**

- NouvLR conducted this assessment.
- Blasting is performed by highly specialized and qualified workers who are not available on weekends – human resources verified this.
- Safety is the priority: we must have the best people on site for this operation.



# Community relations



# Community relations

## Actions

- Clean-up party around the construction site on Saturday, May 11
- Meetings with residents: Saint-Germain d'Outremont School and Université de Montréal
- Communications sent out to invite residents to the committee meetings and to present the next work phases



# Community relations

## **Complaints – 11 complaints received since the last meeting**

- Idling engines and trucks waiting in front of the school yard
- Gates to truck corridor open
- Trucks driving in front of the school, during prohibited times
- Construction noise at night and on weekends

## **Reminders sent to crews subsequent to complaints received:**

- Turn off truck engines when not moving
- Heavy trucks need to exit the site at the start of prohibited times
- Close gates to truck corridor whenever possible



# Status of ongoing and upcoming work





# Schedule

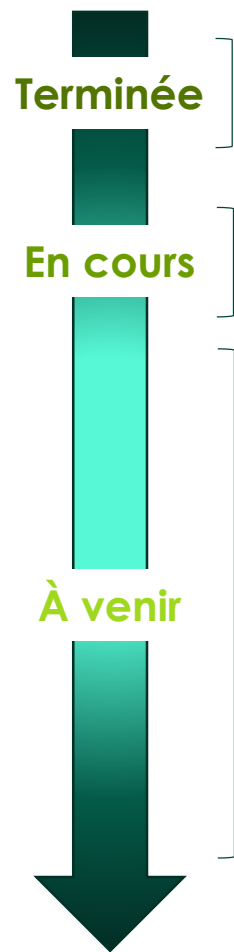

- 1** **Été 2018**  
Travaux préparatoires
  - 2** **Automne 2018**  
Excavation du puits
  - 3** **Été 2019**  
Excavation des galeries
  - 4** **Hiver 2020**  
Construction de la station
  - 5** **Automne 2020**  
Équipement de la station
- 2022 : Mise en service**

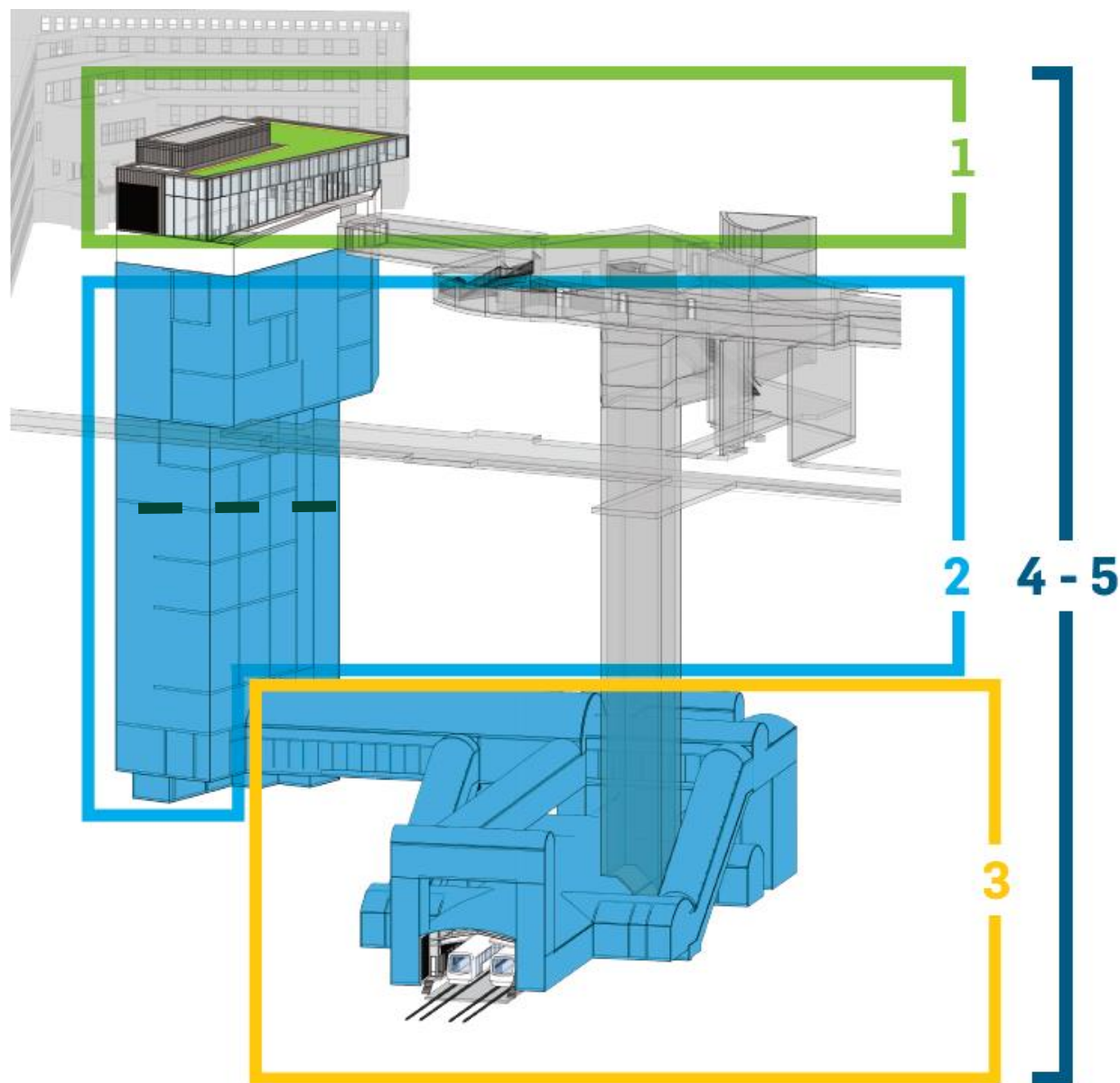

# Work in progress

## Shaft excavation

- When: Fall 2018 to August 2019
- Excavation of the station shaft:
  - Upper portion (mechanical rooms) – 20 m
  - Lower portion (elevators) – 38 m
- Work method:
  - Controlled micro-blasting
  - Vertical excavation in benches

**Depth reached: approximately 39 m**



# Work since end of February

- Concrete work in the shaft
- Construction site improvements:
  - Generator removed  
(construction site now connected to Hydro-Québec service)
  - Addition of an acoustic screen near excavation



# Work since end of February (cont.)

- Compliance with time ranges:
  - Generally 2 to 3 micro-blasts per day
  - Most frequently used windows: 11 a.m. and 9 p.m.
- Average of 15 trucks per day:
  - Charges about every two days, three times per day
- Air quality and noise:
  - Compliance with standards and criteria
  - Work at night – tested on April 16 and 17:
    - Noise levels were consistently exceeded
    - Compliance with day time ranges:

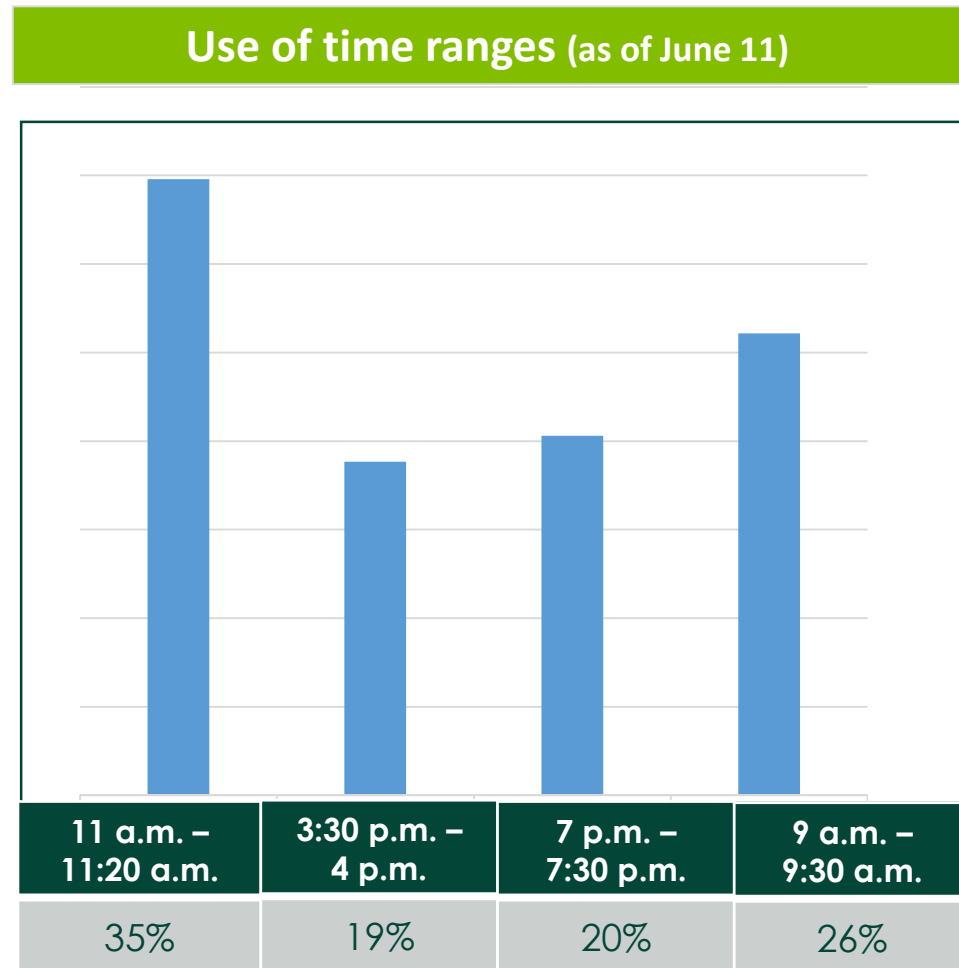

# Upcoming work

## Excavation of underground galleries

- When: August 2019 to early 2020
- Excavation of galleries to connect to the Mount Royal Tunnel
  - Mezzanine, ventilation shafts and elevator shaft (between 60 m and 70 m deep)
- Controlled micro-blasting continues

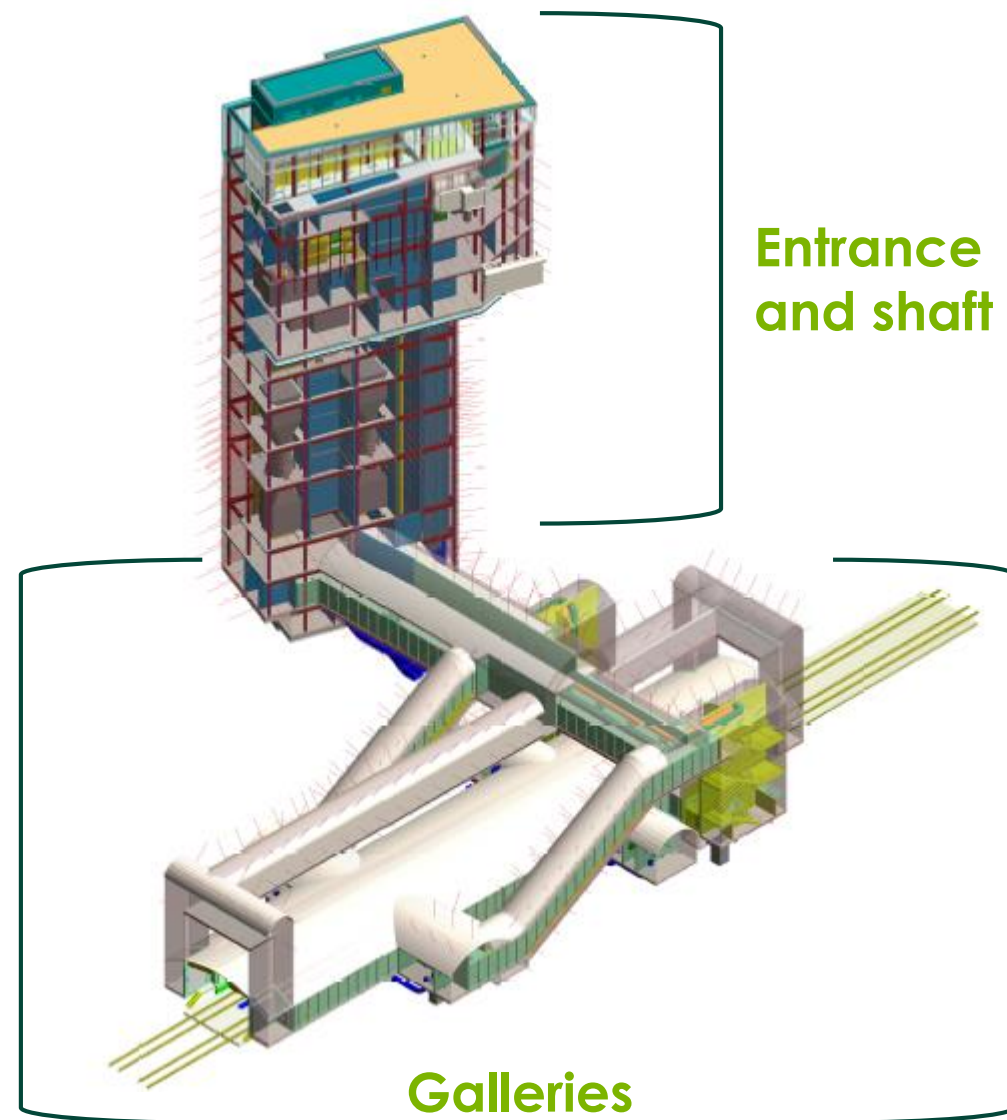

# Characteristics of the underground galleries

- Horizontal excavation in segments
- Galleries varying in size and configurations
- New constraints (worker safety, size of the pieces of rock and time needed to remove them)

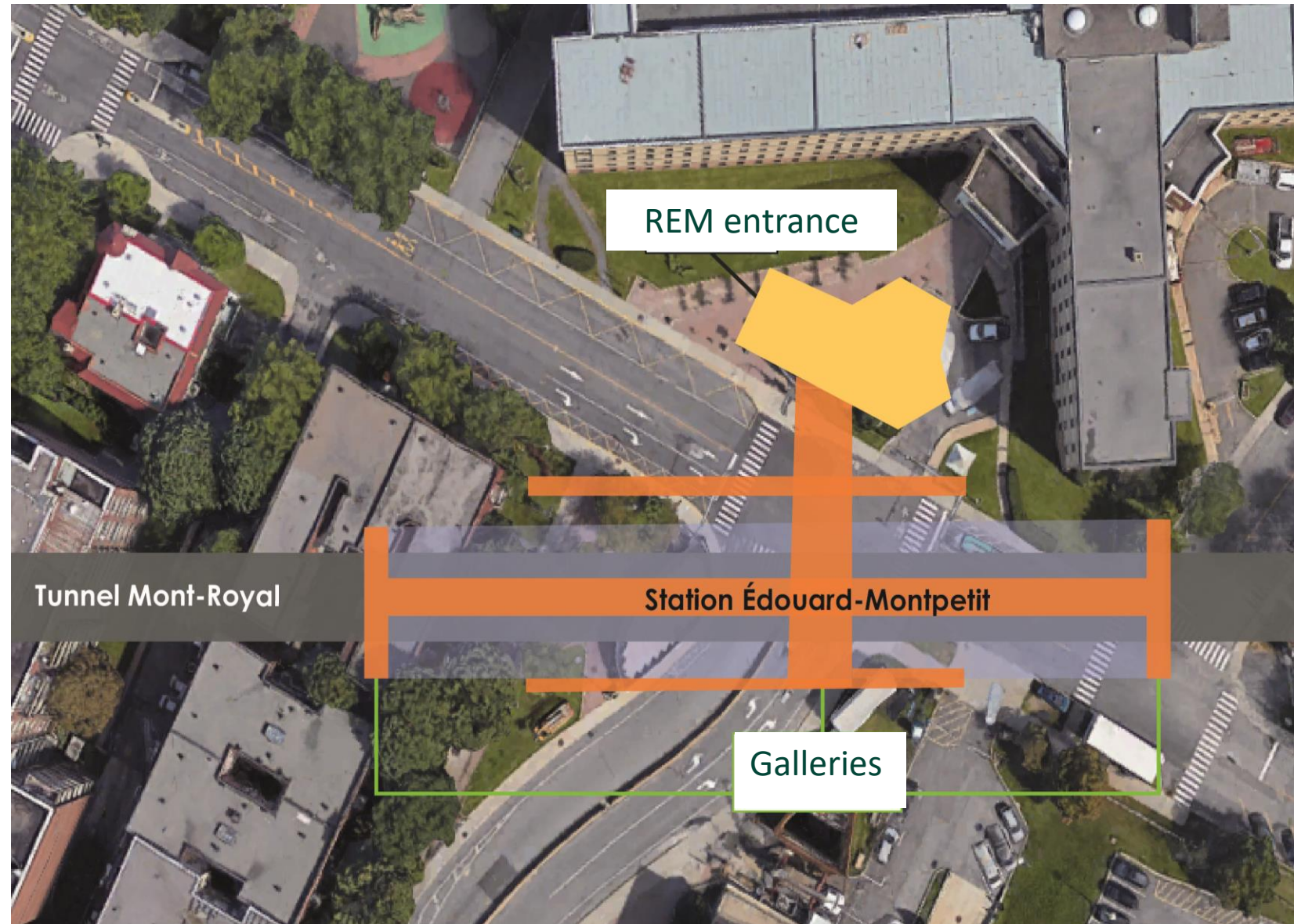

# Characteristics of blasting in a tunnel

- Explosives work against gravity and containment
- Long period delay detonators
- Two-step blasting:

1 Plug blasting

2 Wall blasting

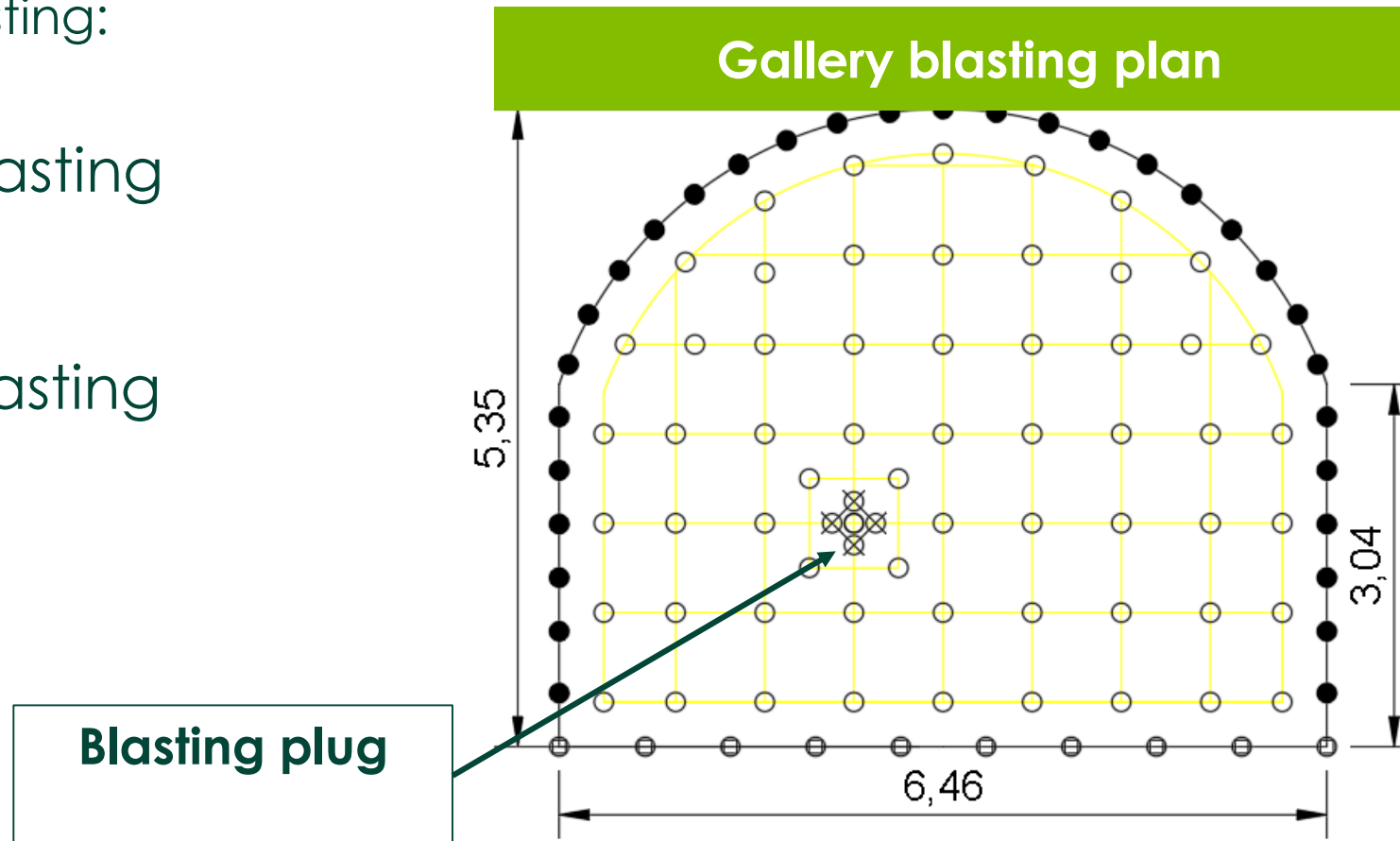

# Anticipated changes

- Slightly different work methods:
  - Excavation of several galleries
  - Excavation moving toward Vincent-D'Indy Ave. and Édouard-Montpetit Blvd.
  - New activities to integrate in the work cycle
- Safety perimeter at street level raised (after excavation progressed past a certain point)
- Longer firing sequence (about 6-8 seconds per blast)
  - Same charge power



# Work cycle

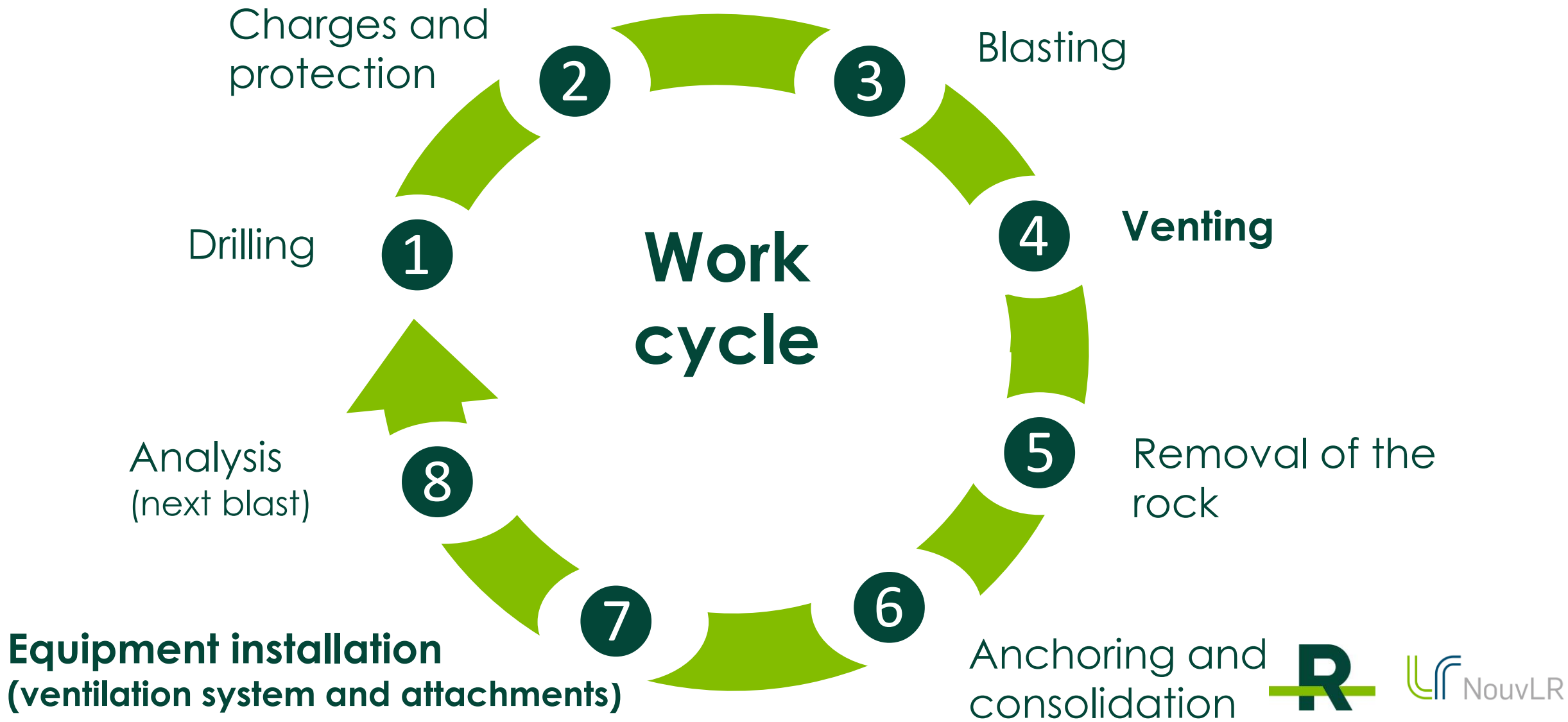

# Maintenance of current practices

- Number of trucks: approx. 20/day
- Environmental monitoring
- Analysis of each blast
- High-quality, adapted equipment



Welcome Air quality Sound level monitoring

---

## Environmental monitoring for the REM construction site



Air quality



Sound levels

# Scheduling of controlled micro-blasting

- Two to three blasts planned per day
- Construction methods currently being finalized – details to come
  - Confirmation by the week of June 17 regarding the new work cycle
- Blasting notices sent 24 hours in advance

# Upcoming work

## Construction of the station

- When: early 2020 until commissioning
- Structural work, concreting and equipment installation:
  - Station structure: early 2020 through the summer
  - Inside: fall 2020 through winter 2021
  - Outside of the entrance and landscaping: 2021 through 2022

**Please note:** work will be carried out in the Mount Royal Tunnel at the same time

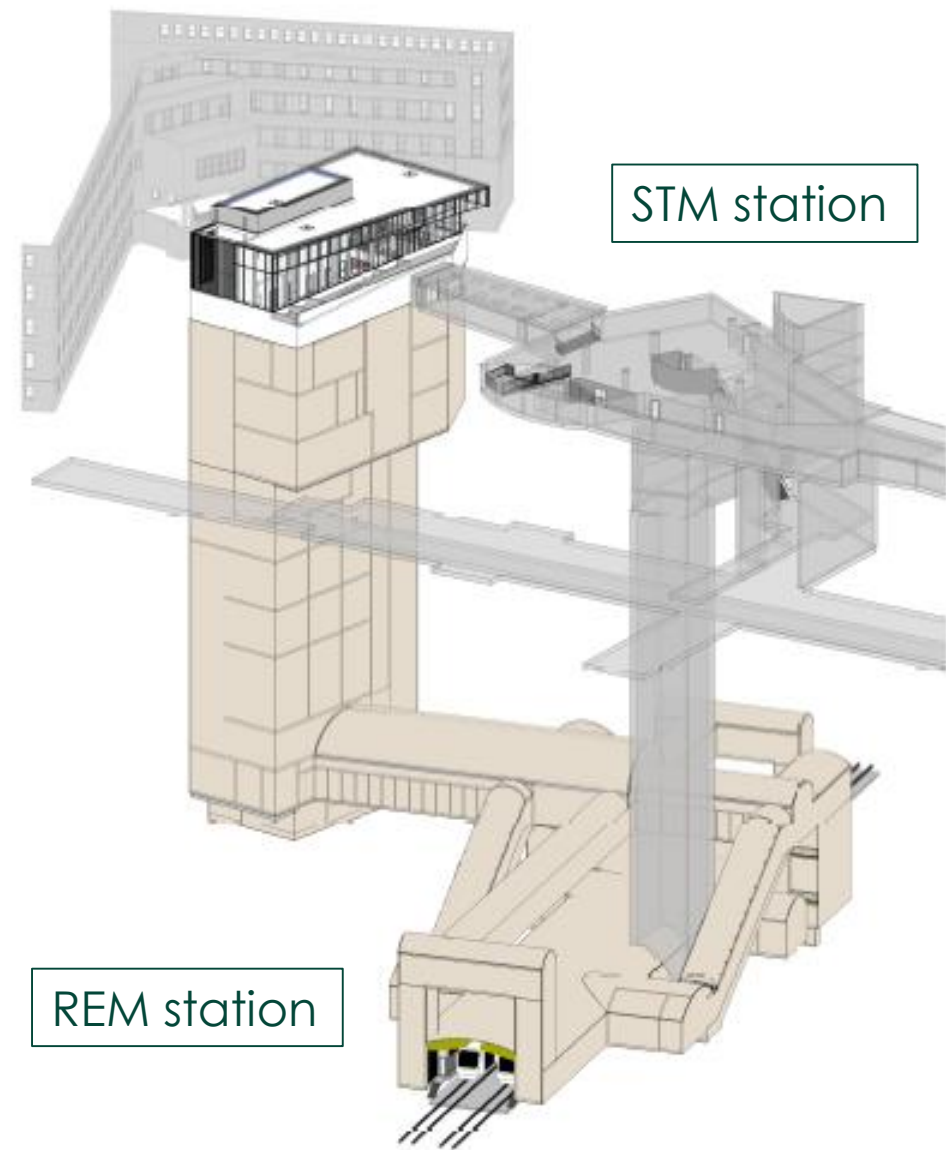



# Question & answer period



A decorative vertical bar on the left side of the slide, consisting of a thick lime green bar with a white circle centered on it.

**Thank you!**

**Next scheduled meeting date:  
September 11 or 12, 2019**



[rem.info/en](http://rem.info/en)

