



# Meeting minutes

- Meeting objective:** Réseau express métropolitain (REM) information meeting
- Date and time:** October 29, 2019, 6 p.m. to 8:30 p.m.
- Location:** Centre socioculturel Alphonse-Lepage, 7905 San Francisco Avenue, Brossard

## Overview:

- Approximately 500 participants
- 6 stakeholders attended the information session and question period
  - o Virginie Cousineau, Public Affairs Manager, REM
  - o Mario Beausoleil, Operations Manager, REM
  - o Alexandre Clouthier, South Shore Site Manager, NouvLR
  - o Nicolas Tanguay, Director, Transport Planning and Development, RTL
  - o Fanie Saint-Pierre, Head of Public Affairs and Communications, ARTM
  - o Pierre Tessier, Facilitator

## Meeting agenda:

- Open house with information panels – 6 p.m. to 7 p.m.
- Information session, followed by a question and answer period – 7:00 p.m. to 9:30 p.m.

## Content of the presentation:

- Project background
- Work completed, in progress and to come until summer 2020
- Construction sites to watch
- Réseau de transport de Longueuil presentation on their consultation process for the redesign of their public transit network

## Main topics addressed by the public during the question period:

- Issues related to REM operations (e.g. derailment risks, winter conditions, evacuation procedures, user safety, universal accessibility)
- Ticket prices and fare structure (by zone, social pricing)
- Station access
- Incentive parking offer in Brossard with the arrival of the REM
- Redesign of the public transit network

The video recording of the information session is available at:

<https://www.youtube.com/watch?v=ZA8qIOgM490>

The documentation presented during the meeting is available at: <https://rem.info/en/events>

See below for the meeting presentation and information panels about the project.

**Presentation begins at 7 p.m.**

**If you have any questions about the project please visit [rem.info/en](http://rem.info/en)**

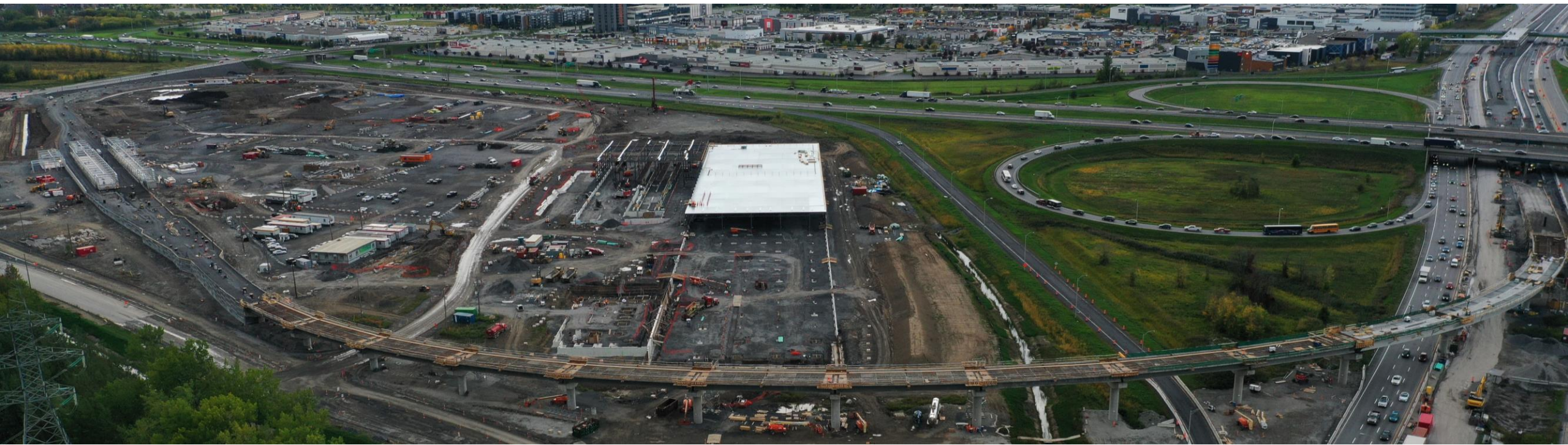



# Réseau express métropolitain

Brossard information meeting

October 29, 2019

Réseau  
express  
métropolitain



# Agenda

- Background
- Major accomplishments 2018-2019
- Upcoming work through summer 2020
- To watch
- Réseau de transport de Longueuil presentation
- Question and answer period



# Background

# Réseau express métropolitain



Largest public transit project in Québec in the last 50 years

Light rail  
100% electric  
and automated

26 stations, 67 km

Commissioning in Brossard in 2021

# Station access

- One condition for the network's success
- Access via public and active transit prioritized
  - Close collaboration with transit companies
- Reopening of parking spaces
  - Toward the Rive-Sud station: to prevent traffic congestion on the local network and service motorists upstream from the Highway 10/30 interchange
  - Panama station: one of the largest bus terminals in the region

# Rive-Sud station

DIX30



De Rome Blvd.

Maintenance Centre and Command Centre

Park-and-ride lot – 3,000 spaces

Bus terminal

REM station



Montée Gobeil overpass

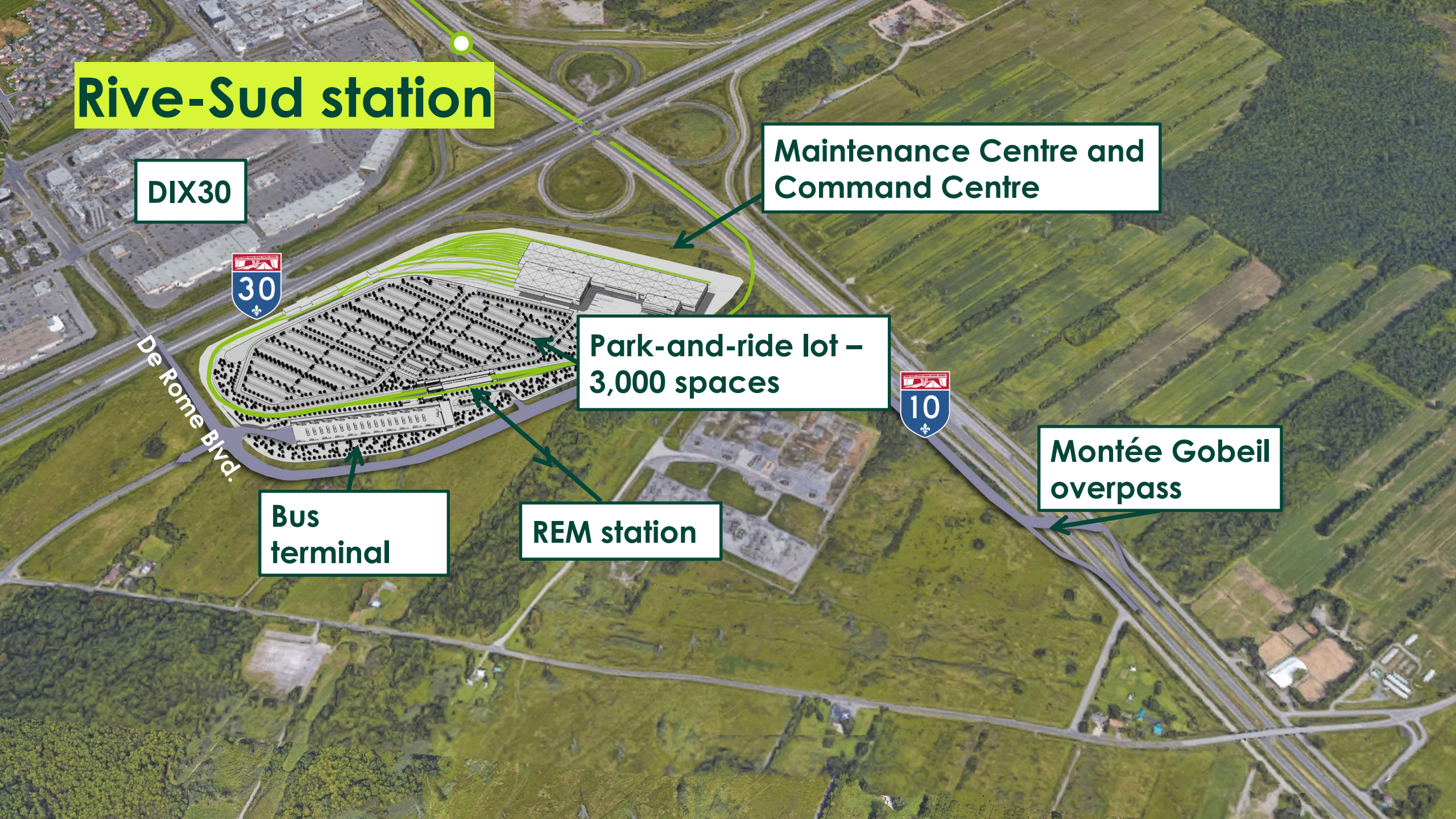



# Rive-Sud station



# Du Quartier station

Du Quartier station

Du Quartier overpass

Solar Uniquartier  
(under construction)



# Du Quartier station



# Panama station

Park-and-ride lot –  
about 200 spaces

Bus  
terminal

Panama station



# Panama station





# Major accomplishments 2018-2019



# Upcoming work through summer 2020

Temporary bus terminal opens  
Construction of the permanent terminal

Drainage work

Panama

Installation of the  
tracks

Preparatory work  
for track installation

Construction  
of the station

Construction of  
the station

De Rome Blvd.

Malo Leduc  
elevated structure



Du Quartier

Montée  
Gobeil  
overpass

Taschereau Blvd.

Building construction (station,  
maintenance centre, etc.)

South  
Shore

Upcoming  
work  
2019-2020





**O To watch**

# Progress on the overpass – Malo/Leduc

- Beam and deck installation
- Concrete work on the deck and curbing
- Night work
- Numerous traffic pattern disruptions expected on Leduc Boulevard and Highway 10 West
- In coordination with Canadian National (CN)

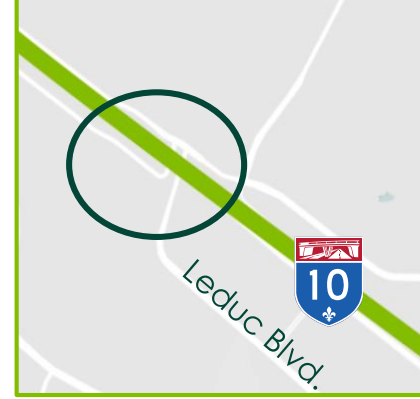

# Panama bus terminal – temporary infrastructures



Panama tunnel  
closes on  
November 1

Total parking  
capacity  
will be  
maintained

# Mobilization – Samuel-De Champlain Bridge approach

- Preparatory work begins
- Between Panama Station and Route 132
- In the Highway 10 median
- Occasional traffic hindrances to be expected



# Important milestones in 2020

- Construction of the **Panama station and future bus terminal**
- **Du Quartier and Rive-Sud stations** completely enclosed



# First tests begin in fall 2020



Panama

Representative segment

Du Quartier

Rive-Sud

# Within the range of REM



Panama  
to Gare  
Centrale



**10** min



Du Quartier to  
Édouard-Montpetit



**17** min.



Rive-Sud station  
to McGill



**19** min



# Réseau de transport de Longueuil's presentation



**Prochain  
arrêt**



Le citoyen au cœur  
de notre réseau

**Public consultations  
in Brossard:  
Key needs identified**



# PARTICIPATION IN THE CONSULTATION

## Two-level consultation

- In-person public consultation in Brossard (June 17, 2019): **200 participants**
- Online consultation: **180 participants**
- **Many partners present**

Total of  
**380**  
participants

# PROFILES OF TWO ADDITIONAL RESPONDENTS

## Integration of results

- ✓ In session: smaller households, who travel less during peak hours and use public transit less frequently
- ✓ Online: larger households, who use public transit more often, especially during peak periods

### Accueil – Profil des participants

#### Utilisation du transport collectif

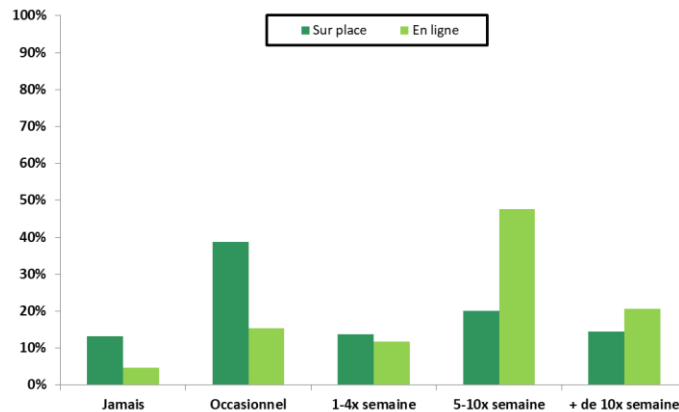

### Accueil – Profil des participants

#### Motif de déplacement le plus fréquent

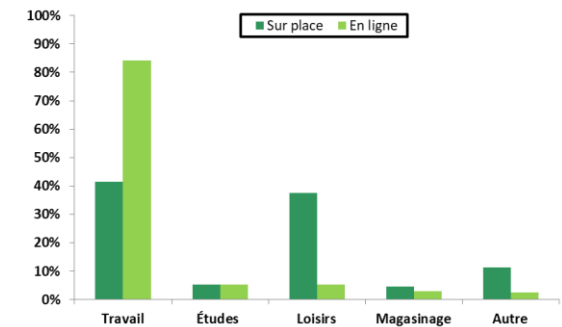

# MAIN PRELIMINARY FINDINGS

- **More frequent local service**
  - ✓ In the urban agglomeration of Longueuil (Brossard and Longueuil)
  - ✓ Fast, frequent service
  - ✓ Local service (walking time less than 10 minutes)
- **More active transit**
  - ✓ Adjustments to existing infrastructure
- **Simplified travel**, thanks in particular to:
  - ✓ Reserved lanes
  - ✓ Comfort

## NEXT STEPS

- Establish a clear picture of the situation and needs
- Feedback from consultation participants and Brossard citizens
- Ongoing communication with citizens and RTL users
- Assessment of all public consultations across the urban agglomeration of Longueuil
- Preparation of the next phases of consultations

## Schedule of upcoming consultations on needs

- **October 30:** public consultation in Boucherville
- **November 6:** public consultation in Longueuil, in the borough of Vieux-Longueuil
- **November 21:** public consultation in Saint-Lambert



<http://www.rtl-longueuil.qc.ca/>



# Question & answer period

Réseau  
express  
métropolitain

 REMgrandmtl

 REMgrandmtl

 1 833 rem-info  
(1 833 736-4636)

 Info@rem.info

[rem.info/en](http://rem.info/en)





# Panama station

**Park-and-ride lot**  
(environ 200 places)

**Bus terminal**

**Panama station**



For reference only

# Panama station



For reference only

# Du Quartier station

Du Quartier station

Du Quartier overpass



**Solar Uniquartier**  
(under construction)

For reference only

# Du Quartier station



For reference only

# Rive-Sud station

Du Quartier station

DIX30



Maintenance Centre  
and Command Centre



Park-and-ride lot  
(3000 places)

Montée Gobeil  
overpass

REM station

Bus terminal

B. de ROME

# Rive-Sud station



For reference only

# Réseau express métropolitain



**3 stations :** Panama, Du Quartier, and Rive-Sud  
 In service **20h per day, 7 days a week**

Every **2,5 minutes** during **peak hour** and **5 minutes off-peak hour**

**Connection to 3 metro lines** and access to the airport, North Shore and West Island



# Upcoming work 2019-2020

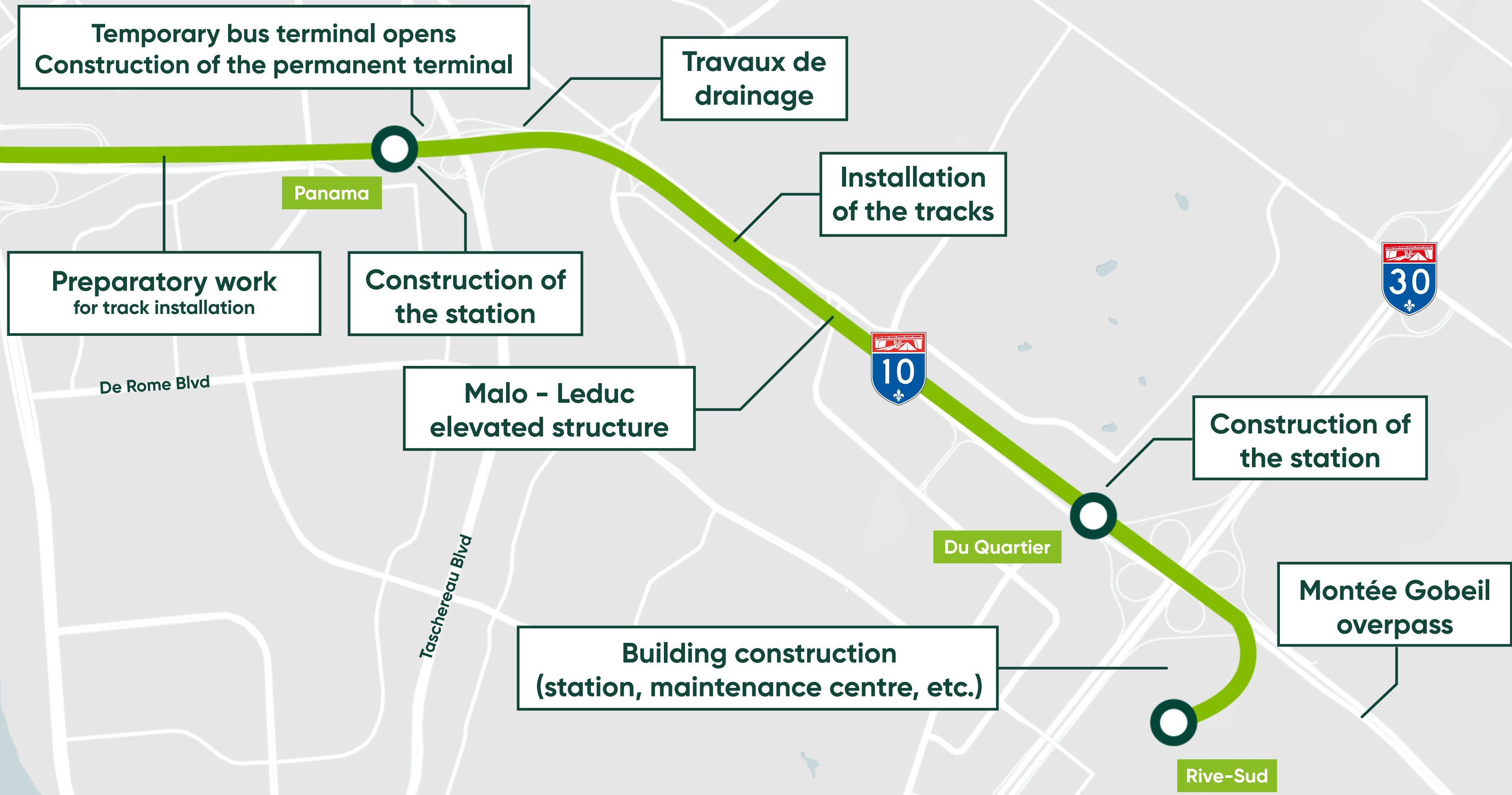

Temporary bus terminal opens  
Construction of the permanent terminal

Travaux de drainage

Installation of the tracks

Preparatory work for track installation

Construction of the station

Malo - Leduc elevated structure

Construction of the station

Building construction (station, maintenance centre, etc.)

Montée Gobeil overpass

Panama

Du Quartier

Rive-Sud

Milan Blvd

Grande Allée

De Rome Blvd

Taschereau Blvd





# Reliability and efficiency

## A high-frequency metro



## A system designed to tackle Québec winters



Winter climate testing phase prior to commissioning in one of the best climatic chambers



# Accessibility and passenger movement

## Universal access

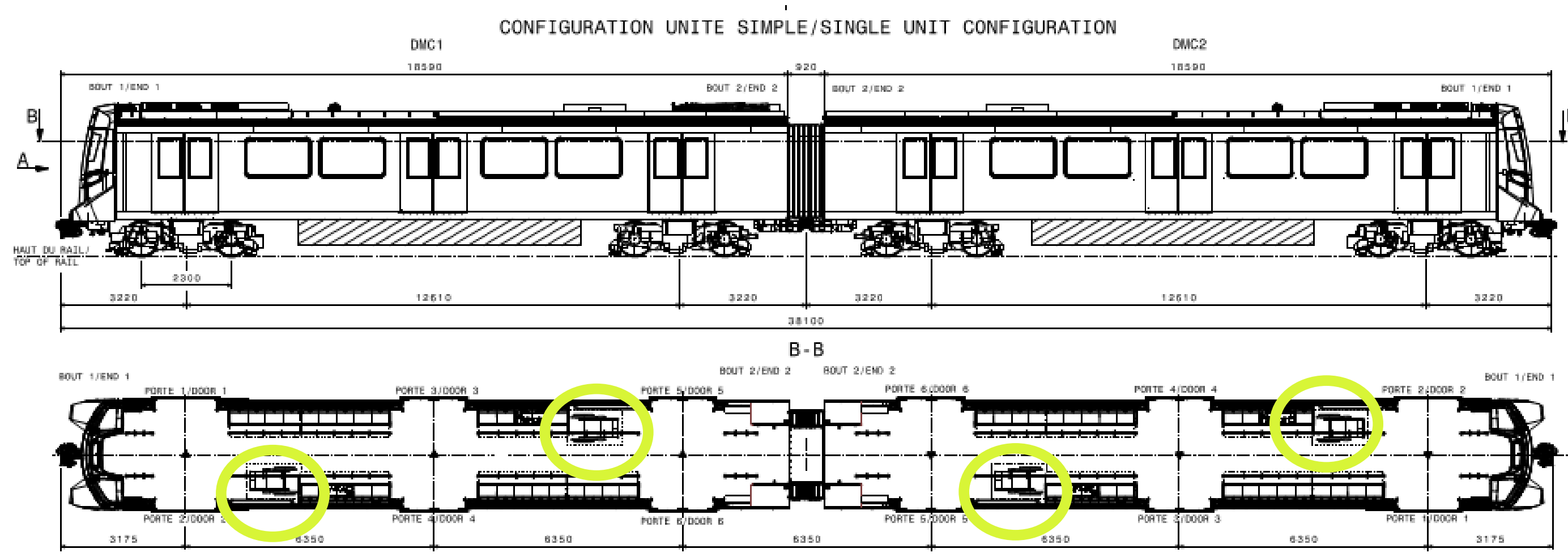
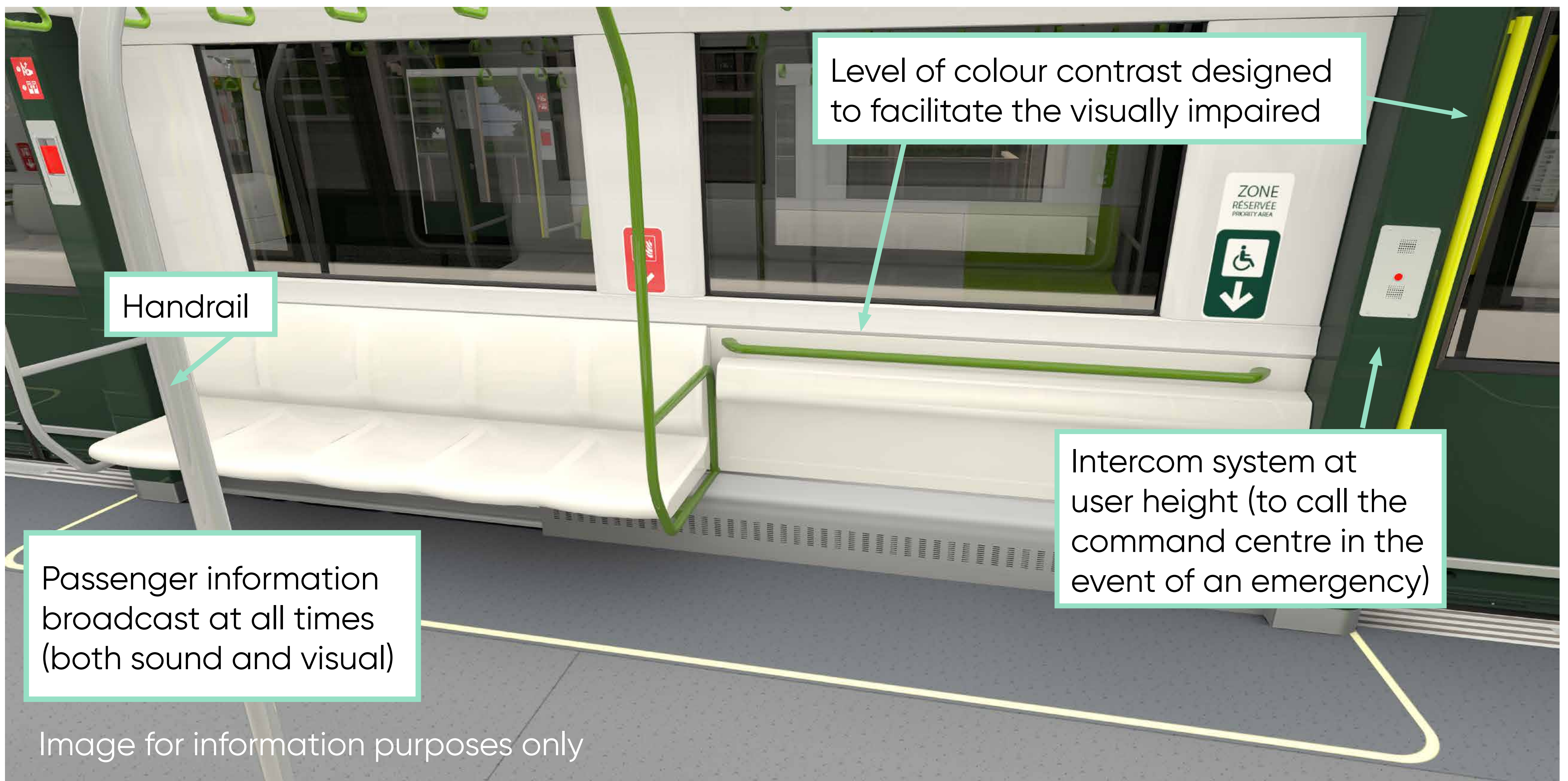

4 reserved spaces per off-peak hours departure  
8 reserved spaces per peak hours departure

Universal access required from the outset and consultations aimed at making adjustments to address specific needs

## Free-flowing passenger movement



Reserved space for:



Families with strollers



Cyclists with bicycles



Commuters with luggage

Seats that are positioned laterally allow for free-flowing passenger movement

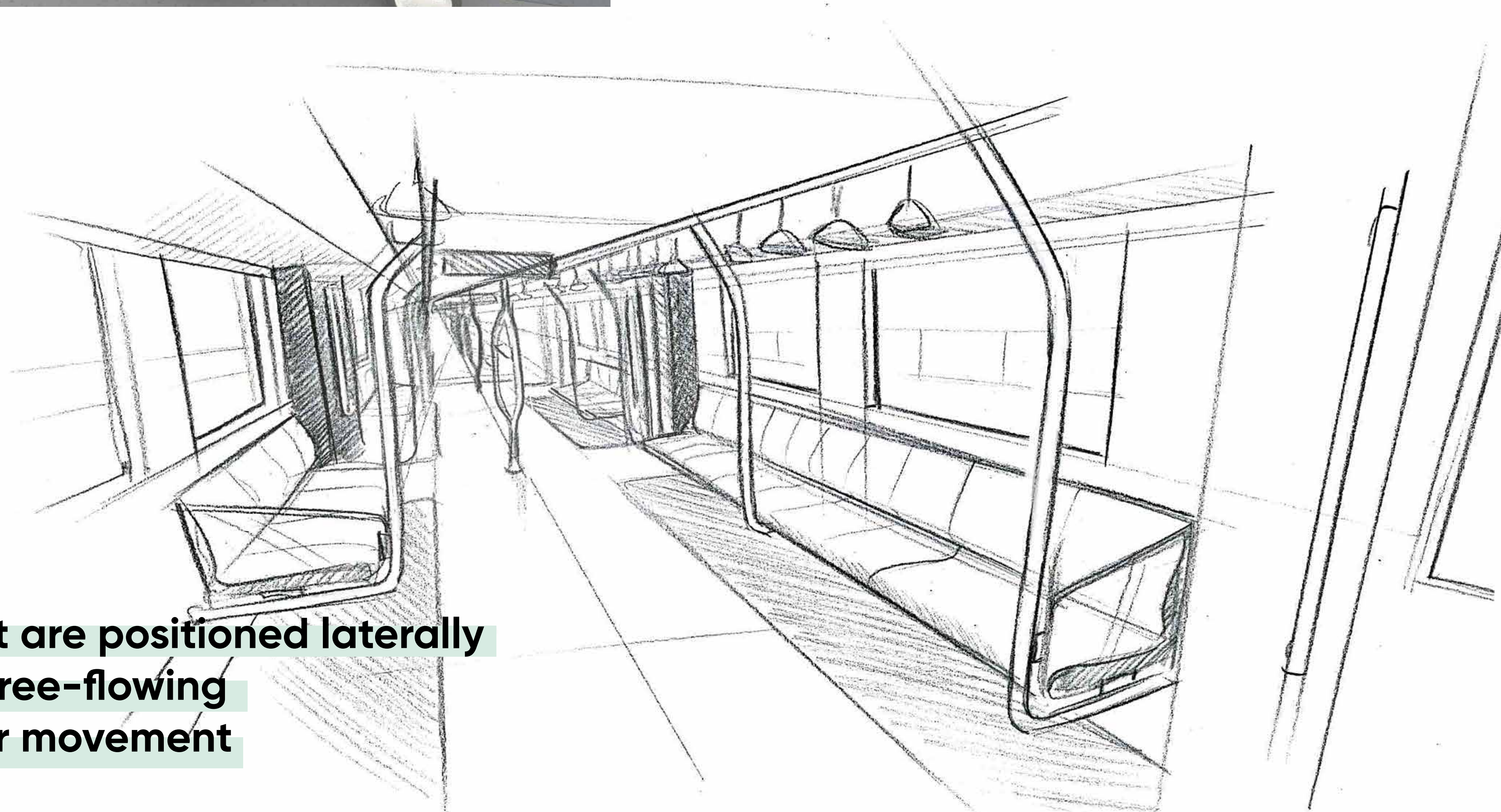

# 26 integrated and enclosed stations

## Enclosed stations



REM stations will be inside enclosed and sheltered buildings. Passengers will be protected from inclement weather while they wait on the platform

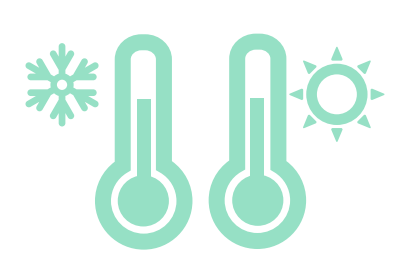

Sheltered stations



Wi-Fi



Platforms are 80 m long

## Categorization

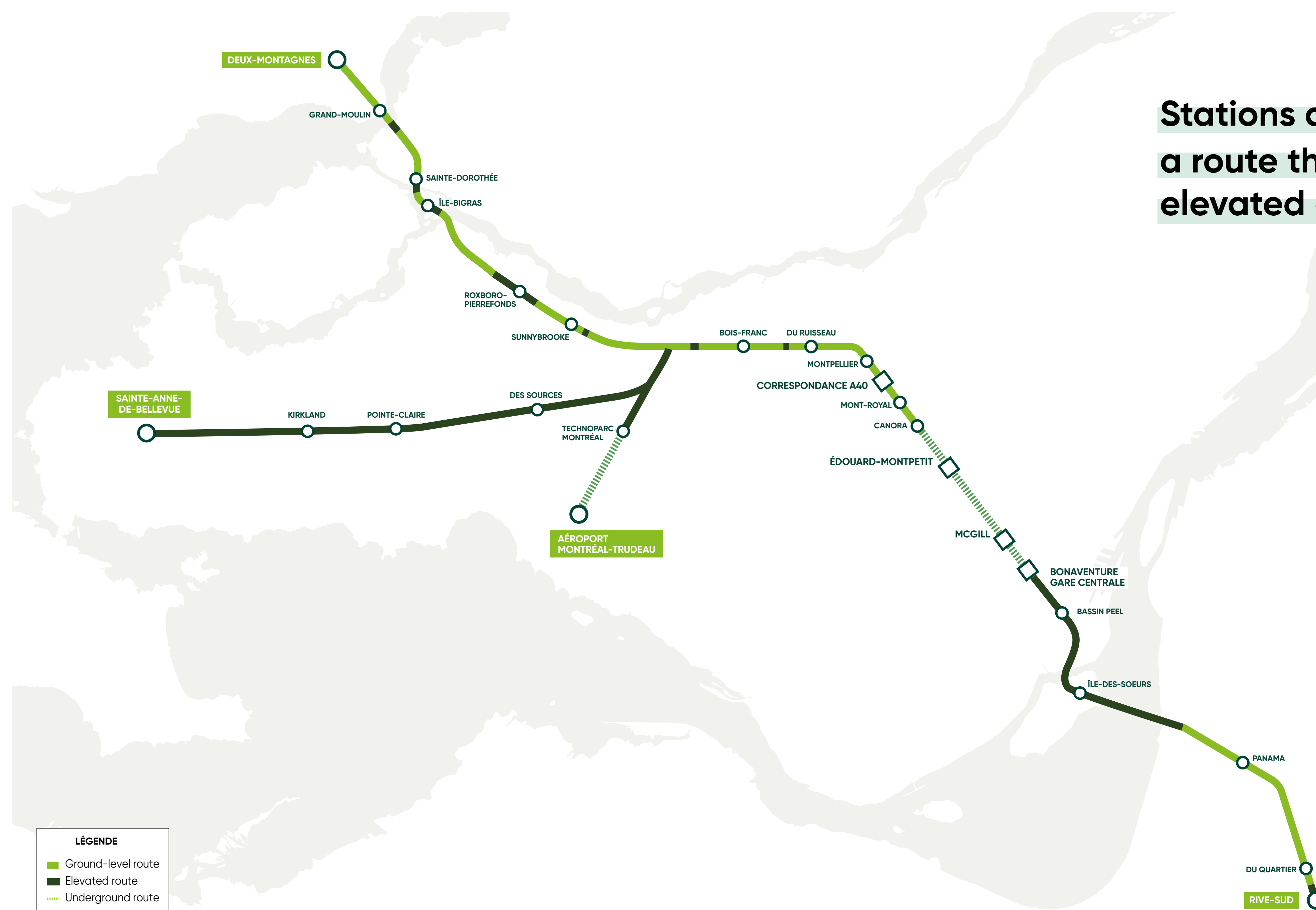

Removal of existing level crossings along the Deux-Montagnes lines, for optimal security.

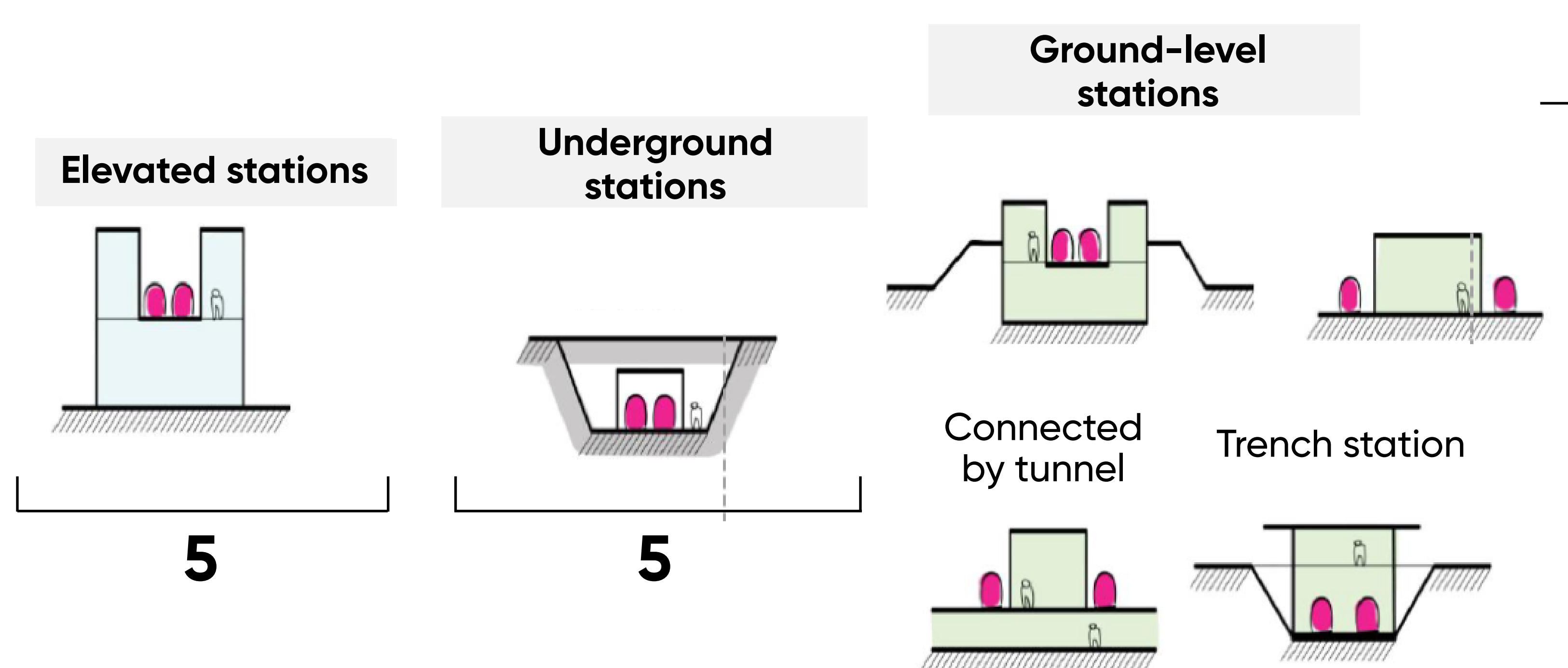

# Architecture

## Materials and design principles

### Glass

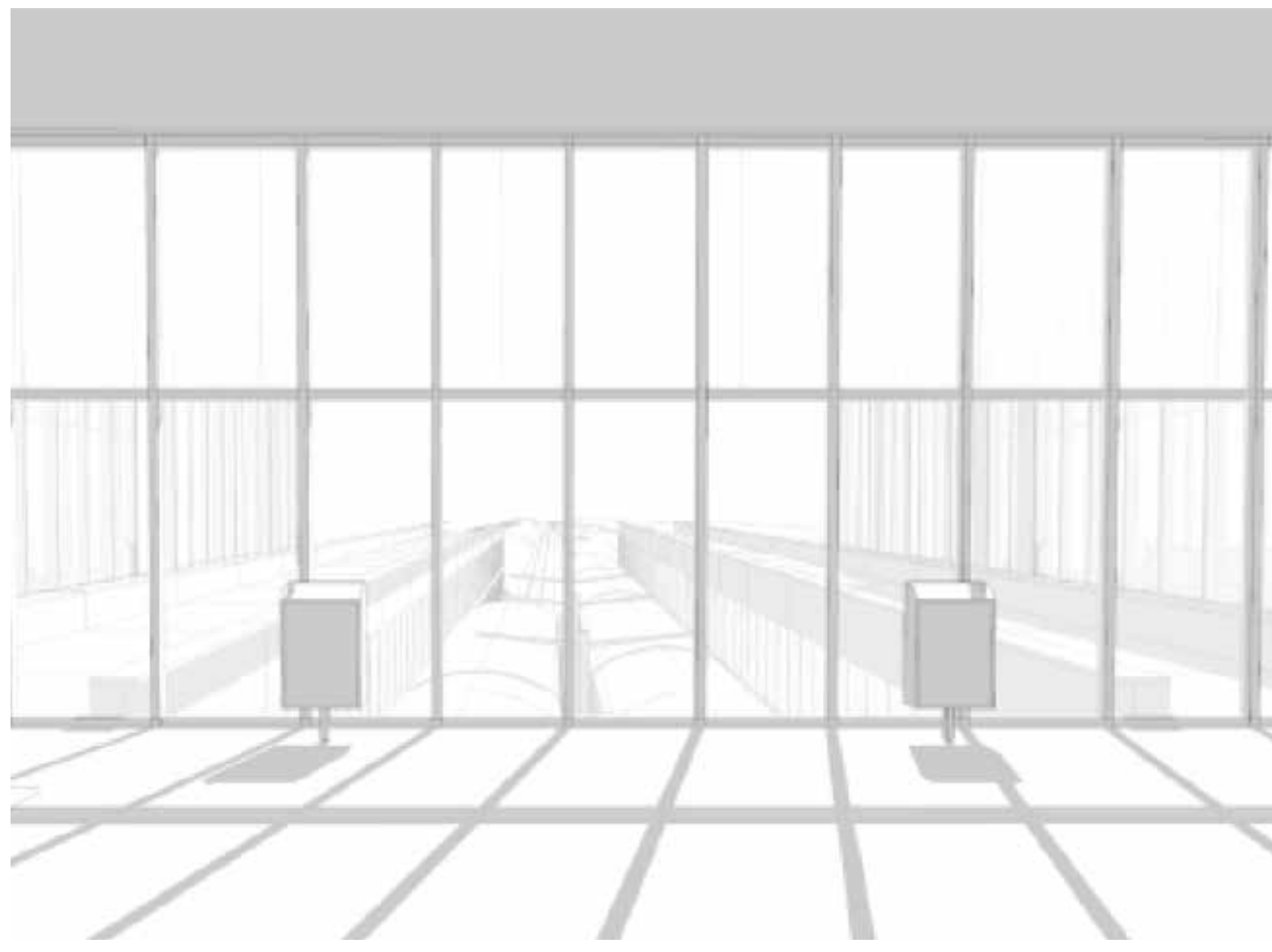

In order to let in as much natural light as possible and for increased safety, the stations are transparent (the concept of seeing and being seen). Fritted glass is used to filter the light.

### Wood



Wood is used on station ceilings to provide warmth in the space. This material is used throughout the building and is an integral part of the architectural concept.

### Movement

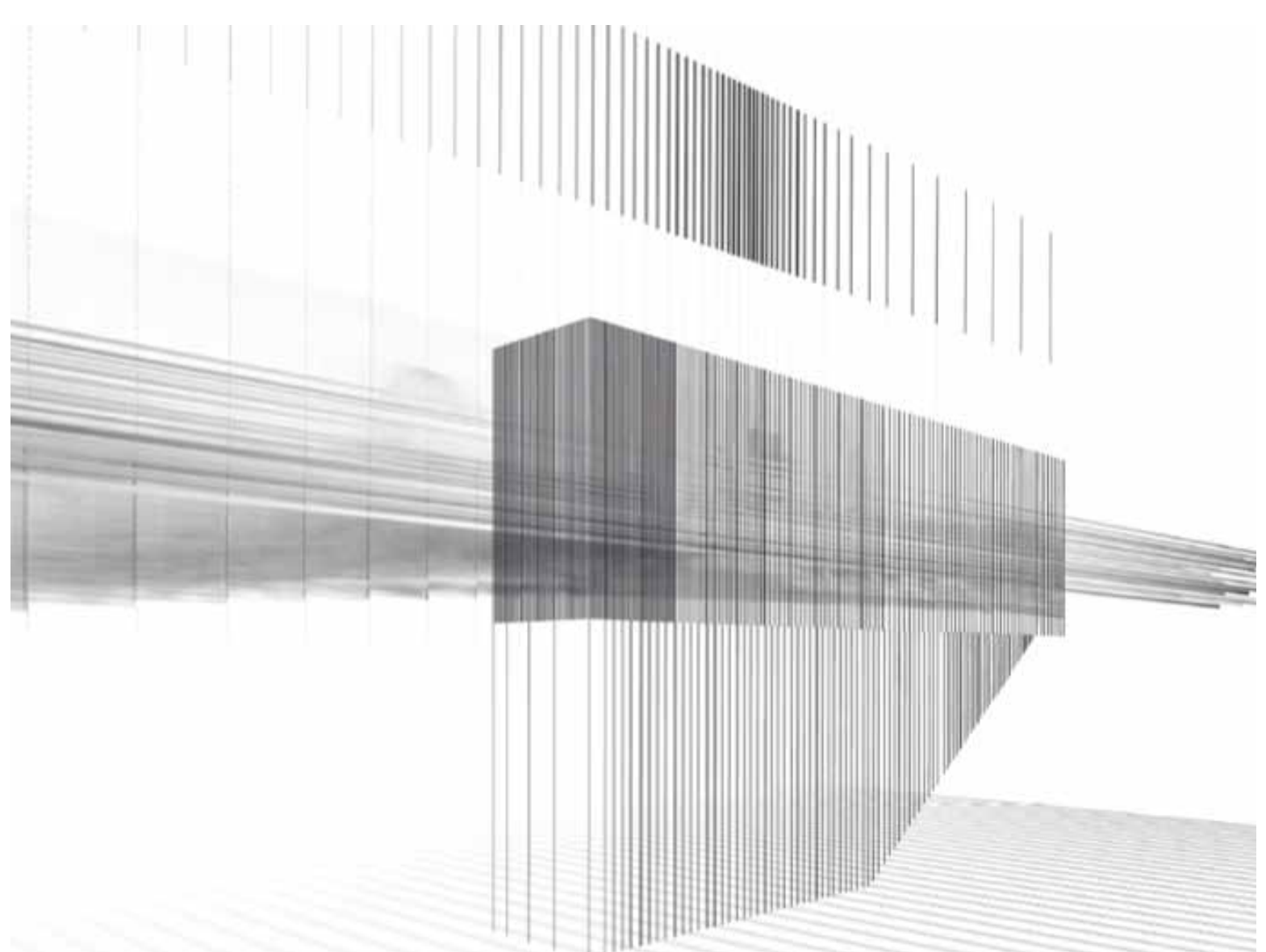

The expression of movement is a theme that is interpreted in a different way in each station. The use of horizontal and vertical lines serves to express movement in the stations.

## Colour strategy

So as to represent the passenger's journey, each branch of the network may be identified by a particular colour that would be visible in the stations, furniture and vegetation.



Coloured surfaces will be visible throughout the stations (tiles, for the most part)

